



## 7d Warwards Lane, Selly Oak, Birmingham, B29 7QX £1,629 Per Calendar Month

 4  1  1  D

2026/2027 ACADEMIC YEAR Spacious Student Accommodation Suitable for Students and Professionals

15 mins walk to University Of Birmingham Campus  
8-10 minutes' walk to mainline train services, Bristol Road shopping, and dining  
4 Double Bedroom Student House  
Walk to Selly Oak Train Station  
Spacious Bedrooms with Quality Furniture  
Modern Kitchen and Comfortable Living Room  
Well-Maintained Garden for Relaxation  
Gas Central Heating  
Security Alarm  
LOW DEPOSIT: £400/person (based on a group of 4 people)  
Available : Rent with Built-in Unlimited Bills Package for only £127.90 per person per week

Spacious 4 Double Bedroom Student House on Warwards Lane, Selly Oak, available for both students and working professionals. This well-maintained property features comfortable and generously sized bedrooms, a modern kitchen, and a cozy living room with leather sofas. The house also boasts a lovely garden for relaxation. It's conveniently located within walking distance of Selly Oak Train Station, and each bedroom is furnished with quality furniture. With gas central heating and alarm systems, this house offers both comfort and security for its residents.

Don't miss your chance to view this exceptional property. Schedule a viewing by appointment only with MKP Management. Your dream home in Selly Oak awaits!

### Viewing

Please contact our MKP MANAGEMENT Office on 0121 472 5897 if you wish to arrange a viewing appointment for this property or require further information.

MKP



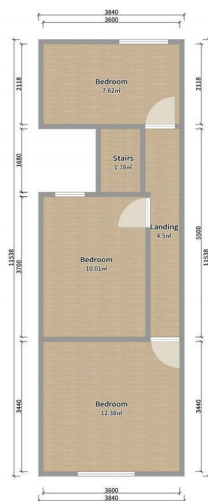

### Energy Efficiency Rating

Rating	Current	Potential
(92 plus) A		
(81-91) B		83
(69-80) C		
(55-68) D	65	
(39-54) E		
(21-38) F		
(1-20) G		

Very energy efficient - lower running costs

Not energy efficient - higher running costs

### Environmental Impact (CO<sub>2</sub>) Rating

Rating	Current	Potential
(92 plus) A		
(81-91) B		87
(69-80) C		
(55-68) D	66	
(39-54) E		
(21-38) F		
(1-20) G		

Very environmentally friendly - lower CO<sub>2</sub> emissions

Not environmentally friendly - higher CO<sub>2</sub> emissions

**England & Wales**

EU Directive 2002/91/EC

**England & Wales**

EU Directive 2002/91/EC

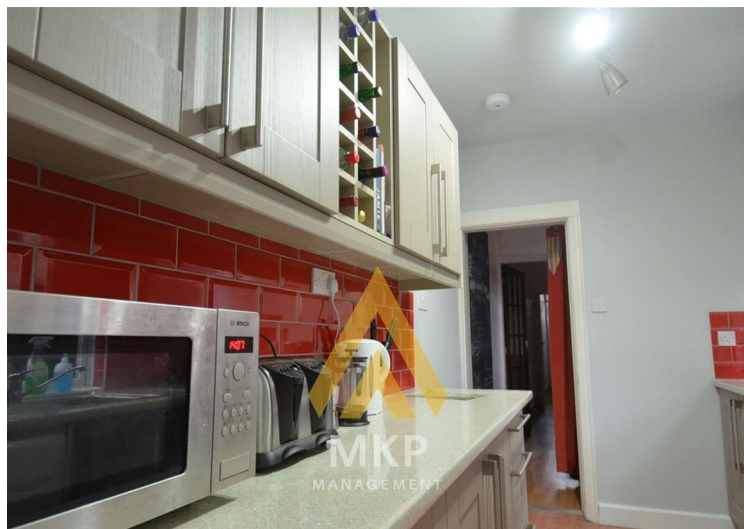

These particulars, whilst believed to be accurate are set out as a general outline only for guidance and do not constitute any part of an offer or contract. Intending purchasers should not rely on them as statements of representation of fact, but must satisfy themselves by inspection or otherwise as to their accuracy. No person in this firm's employment has the authority to make or give any representation or warranty in respect of the property.